

# BY-5C 止推垫圈 Thrust Washers

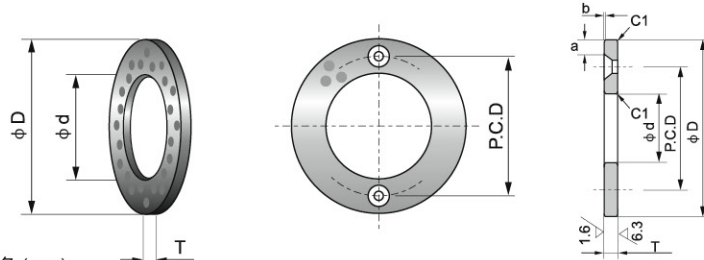

●能与JDB组合使用。

请从适用的内径、外径、长度中选择零件号  
(例)内径30.2mm、厚度5mm的情况下



a b: 端面倒角 (mm)

$\phi d$	~10.2	~18.2	~35.2	~45.2	~55.3	~100.5	~120.5
a	1.5	2	2.5	3	4	5	4
b	0.3	0.4	0.4	0.5	0.6	0.8	0.8

单位Unit: mm

型号 Parts No.	内径		外径	厚度		定位孔		
	$\phi d$	$\phi d$	$\phi D$	T	0	P.C.D	个数	定位螺栓
BY-5C-0603	6.2	+0.2	25	3	0	15	2	M3
BY-5C-0803	8.2	"	28	"	"	18	"	"
BY-5C-1003	10.2	"	30	"	"	20	"	"
BY-5C-1203	12.2	"	40	"	"	28	"	"
BY-5C-1203N	"	"	"	"	"	无定位孔		
BY-5C-1303	13.2	"	"	"	"	28	2	M3
BY-5C-1403	14.2	"	"	"	"	"	"	"
BY-5C-1503	15.2	"	50	"	"	35	"	"
BY-5C-1603	16.2	"	"	"	"	"	"	"
BY-5C-1603N	"	"	"	"	"	无定位孔		
BY-5C-1803	18.2	"	"	"	"	35	2	M3
BY-5C-2005	20.2	"	"	5	"	"	"	M5
BY-5C-2505	25.2	"	55	"	"	40	"	"
BY-5C-2505N	"	"	"	"	"	无定位孔		
BY-5C-3005	30.2	"	60	"	"	45	2	M5
BY-5C-3005N	"	"	"	"	"	无定位孔		
BY-5C-3505	35.2	"	70	"	"	50	2	M5
BY-5C-4007	40.2	+0.2	80	7	0	60	2	M6
BY-5C-4507	45.2	"	90	"	"	70	"	"
BY-5C-5008	50.3	+0.3	100	8	"	75	4	"
BY-5C-5508	55.3	"	110	"	"	85	"	"
BY-5C-6008	60.3	"	120	"	"	90	"	M8
BY-5C-6508	65.3	"	125	"	"	95	"	"
BY-5C-7010	70.3	"	130	10	"	100	"	"
BY-5C-7510	75.3	"	140	"	"	110	"	"
BY-5C-8010	80.3	"	150	"	"	120	"	"
BY-5C-9010	90.5	"	170	"	"	140	"	M10
BY-5C-10010	100.5	"	190	"	"	160	"	"
BY-5C-12010	120.5	"	200	"	"	175	"	"