

BY-6 轴套 Cylindrical Bushes

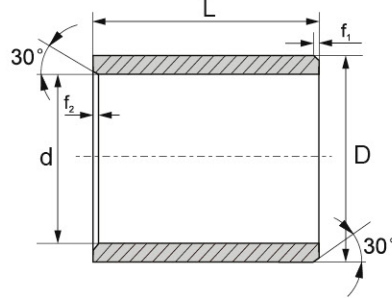

●摩擦面为树脂层。



推荐安装公差 Recommend fitting tolerance:

座孔 Housing: H7

轴 Shaft: h9

订货型号 Order:

BY-6 -0608-06
 d D L

材料 Material

d	f ₁	f ₂
d ≤ 10	0.5	0.5
10 < d ≤ 30	0.8	0.5
30 < d	1.2	0.5

单位 Unit: mm

型号 Parts No.	d mm	d-公差 After fitting mm	D mm	L(h13) mm
BY-6-0304-05	3	+0.014+0.054	4.5	5
BY-6-0304-06	3	+0.014+0.054	4.5	6
BY-6-0305-05	3	+0.014+0.054	5.5	5
BY-6-0405-04	4	+0.020+0.068	5.5	4
BY-6-0405-06	4	+0.020+0.068	5.5	6
BY-6-0406-06	4	+0.020+0.068	6	6
BY-6-0507-05	5	+0.020+0.068	7	5
BY-6-0507-08	5	+0.020+0.068	7	8
BY-6-0507-10	5	+0.020+0.068	7	10
BY-6-0507-18	5	+0.020+0.068	7	18
BY-6-0608-04	6	+0.020+0.068	8	4
BY-6-0608-05	6	+0.020+0.068	8	5
BY-6-0608-06	6	+0.020+0.068	8	6
BY-6-0608-08	6	+0.020+0.068	8	8
BY-6-0608-10	6	+0.020+0.068	8	10
BY-6-0810-05	8	+0.025+0.083	10	5
BY-6-0810-06	8	+0.025+0.083	10	6
BY-6-0810-08	8	+0.025+0.083	10	8
BY-6-0810-10	8	+0.025+0.083	10	10
BY-6-0810-12	8	+0.025+0.083	10	12
BY-6-0810-15	8	+0.025+0.083	10	15
BY-6-1012-04	10	+0.025+0.083	12	4
BY-6-1012-05	10	+0.025+0.083	12	5
BY-6-1012-06	10	+0.025+0.083	12	6
BY-6-1012-07	10	+0.025+0.083	12	6
BY-6-1012-08	10	+0.025+0.083	12	8

型号 Parts No.	d mm	d-公差 After fitting mm	D mm	L(h13) mm
BY-6-1012-09	10	+0.025+0.083	12	6
BY-6-1012-10	10	+0.025+0.083	12	10
BY-6-1012-12	10	+0.025+0.083	12	12
BY-6-1012-15	10	+0.025+0.083	12	15
BY-6-1012-18	10	+0.025+0.083	12	18
BY-6-1012-20	10	+0.025+0.083	12	20
BY-6-1214-04	12	+0.032+0.102	14	6
BY-6-1214-06	12	+0.032+0.102	14	6
BY-6-1214-08	12	+0.032+0.102	14	8
BY-6-1214-09	12	+0.032+0.102	14	9
BY-6-1214-10	12	+0.032+0.102	14	10
BY-6-1214-12	12	+0.032+0.102	14	12
BY-6-1214-14	12	+0.032+0.102	14	12
BY-6-1214-15	12	+0.032+0.102	14	15
BY-6-1214-20	12	+0.032+0.102	14	20
BY-6-1214-25	12	+0.032+0.102	14	25
BY-6-1315-07	13	+0.032+0.102	15	7
BY-6-1315-10	13	+0.032+0.102	15	10
BY-6-1315-15	13	+0.032+0.102	15	15
BY-6-1416-08	14	+0.032+0.102	16	8
BY-6-1416-10	14	+0.032+0.102	16	10
BY-6-1416-15	14	+0.032+0.102	16	15
BY-6-1416-20	14	+0.032+0.102	16	20
BY-6-1416-25	14	+0.032+0.102	16	25
BY-6-1517-10	15	+0.032+0.102	17	10
BY-6-1517-12	15	+0.032+0.102	17	12

BY-6 轴套 Cylindrical Bushes

型号 Parts No.	d mm	d-公差 After fitting mm	D mm	L(h13) mm	型号 Parts No.	d mm	d-公差 After fitting mm	D mm	L(h13) mm
BY-6-1517-15	15	+0.032 +0.102	17	15	BY-6-2832-25	28	+0.040 +0.124	32	25
BY-6-1517-17	15	+0.032 +0.102	17	17	BY-6-2832-30	28	+0.040 +0.124	32	30
BY-6-1517-20	15	+0.032 +0.102	17	20	BY-6-3034-15	30	+0.040 +0.124	34	15
BY-6-1517-25	15	+0.032 +0.102	17	25	BY-6-3034-20	30	+0.040 +0.124	34	20
BY-6-1618-10	16	+0.032 +0.102	18	10	BY-6-3034-25	30	+0.040 +0.124	34	25
BY-6-1618-12	16	+0.032 +0.102	18	12	BY-6-3034-30	30	+0.040 +0.124	34	30
BY-6-1618-15	16	+0.032 +0.102	18	15	BY-6-3034-40	30	+0.040 +0.124	34	40
BY-6-1618-20	16	+0.032 +0.102	18	20	BY-6-3236-20	32	+0.050 +0.150	36	20
BY-6-1618-25	16	+0.032 +0.102	18	25	BY-6-3236-25	32	+0.050 +0.150	36	25
BY-6-1820-10	18	+0.032 +0.102	20	10	BY-6-3236-30	32	+0.050 +0.150	36	30
BY-6-1820-12	18	+0.032 +0.102	20	12	BY-6-3236-40	32	+0.050 +0.150	36	40
BY-6-1820-15	18	+0.032 +0.102	20	15	BY-6-3539-20	35	+0.050 +0.150	39	20
BY-6-1820-20	18	+0.032 +0.102	20	20	BY-6-3539-25	35	+0.050 +0.150	39	25
BY-6-1820-25	18	+0.032 +0.102	20	25	BY-6-3539-30	35	+0.050 +0.150	39	30
BY-6-2022-12	20	+0.040 +0.124	22	12	BY-6-3539-40	35	+0.050 +0.150	39	40
BY-6-2022-15	20	+0.040 +0.124	22	15	BY-6-3539-50	35	+0.050 +0.150	39	50
BY-6-2022-28	20	+0.040 +0.124	22	28	BY-6-4044-20	40	+0.050 +0.150	44	20
BY-6-2023-10	20	+0.040 +0.124	23	10	BY-6-4044-30	40	+0.050 +0.150	44	30
BY-6-2023-15	20	+0.040 +0.124	23	15	BY-6-4044-40	40	+0.050 +0.150	44	40
BY-6-2023-20	20	+0.040 +0.124	23	20	BY-6-4044-50	40	+0.050 +0.150	44	50
BY-6-2023-23	20	+0.040 +0.124	23	23	BY-6-4550-30	45	+0.050 +0.150	50	30
BY-6-2023-25	20	+0.040 +0.124	23	25	BY-6-4550-40	45	+0.050 +0.150	50	40
BY-6-2023-30	20	+0.040 +0.124	23	30	BY-6-4550-50	45	+0.050 +0.150	50	50
BY-6-2225-15	22	+0.040 +0.124	25	15	BY-6-5055-20	50	+0.050 +0.150	55	20
BY-6-2225-20	22	+0.040 +0.124	25	20	BY-6-5055-25	50	+0.050 +0.150	55	25
BY-6-2225-25	22	+0.040 +0.124	25	25	BY-6-5055-30	50	+0.050 +0.150	55	30
BY-6-2225-30	22	+0.040 +0.124	25	30	BY-6-5055-40	50	+0.050 +0.150	55	40
BY-6-2528-10	25	+0.040 +0.124	28	10	BY-6-5055-50	50	+0.050 +0.150	55	50
BY-6-2528-12	25	+0.040 +0.124	28	12	BY-6-5560-40	55	+0.060 +0.180	60	40
BY-6-2528-15	25	+0.040 +0.124	28	15	BY-6-5560-50	55	+0.060 +0.180	60	50
BY-6-2528-20	25	+0.040 +0.124	28	20	BY-6-5560-60	55	+0.060 +0.180	60	60
BY-6-2528-25	25	+0.040 +0.124	28	25	BY-6-6065-30	60	+0.060 +0.180	65	30
BY-6-2528-30	25	+0.040 +0.124	28	30	BY-6-6065-40	60	+0.060 +0.180	65	40
BY-6-2832-15	28	+0.040 +0.124	32	15	BY-6-6065-50	60	+0.060 +0.180	65	50
BY-6-2832-20	28	+0.040 +0.124	32	20	BY-6-7580-40	75	+0.060 +0.180	80	40